



Kung Fu Panda™

Takeout Box Pop-up Card

ASSEMBLY INSTRUCTIONS

Time to Complete: Approximately 30 minutes

Level: Medium

GETTING STARTED

Materials:

- Metal-edged ruler
- Butter knife
- Scissors or X-ACTO knife
- Cutting mat (optional)
- Multipurpose glue

1. Be sure to follow the printing instructions for double-sided printing when you download your artwork.

2. Score: Using a metal ruler as a guide, run the back side of a butter knife firmly along the dotted lines on all pieces.



3. Using scissors or X-ACTO knife and cutting mat, cut out pieces on solid lines. Be sure to cut the interior cut lines near glue tab on both pieces.



ASSEMBLE YOUR TAKEOUT BOX

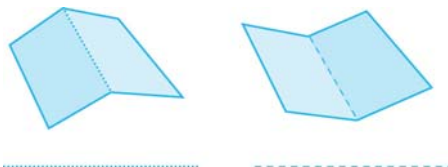

4. Fold dotted lines into mountain and valley folds as indicated on sides 1 and 2.

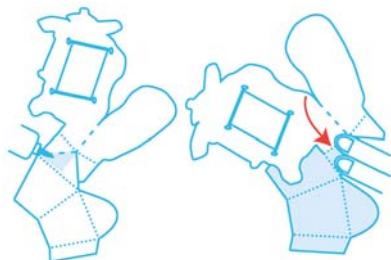

5. On the scroll piece, place a dab of glue on tab A and fold down to adhere. Hold firmly until completely dry. Repeat with tab D on the Tigress piece.

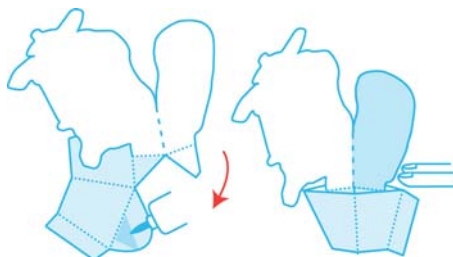

6. On scroll piece, place a dab of glue on tab B and adhere to corresponding shape where indicated. Hold firmly until completely dry. Repeat with tab E on Tigress piece.

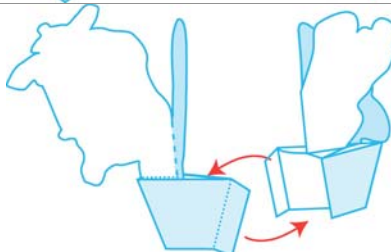

7. Fit the two sides of the take out box together, and adhere by gluing tabs C and F to the inside where marked.

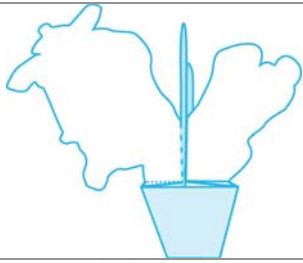

8. You're done.

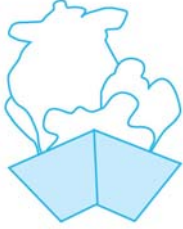

9. To mail your card, gently squeeze two opposite box corners together until the card folds flat.